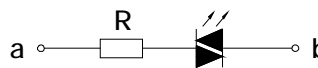

Part-number Description >>

LAS2	GQ	★	—	□	■	◇	/	△	/	▲	/	◎	/	☆
Code of series	Code name	The front shape F Flat Round H High Round C Concave Round G High Concave Round	Contact structure: 11 1NO1NC 22 2NO2NC	Operation mode: Z Latching type No letter means momentary	Lamp type D Dot E Ring	Lamp color and colorized button R Red G Green Y Yellow O Orange B Blue W White	Lamp voltage: AC/DC 6V AC/DC 12V AC/DC 24V AC/DC 110V AC/DC 220V Note: Other voltage can be made to order	The crust material: N Nickel-plated Brass S Stainless steel	IP degree FP IP67 No letter means IP40 Pls check the detailed IP degree from P37					

Note: Pls read the catalog carefully ,and choose the right part - number according to the sign.

Lamp Ratings >>

Lamp Type	LED lamp(AC/DC)			Lamp Circuit Diagram	<div></div> <p>⦿ Using AC/DC LED lamp, the terminals have no difference of anode and cathode:</p> <p>⦿ Using inner resistance for the lamp below 60V. Using 6V lamp when the lamp voltage is above 60V, and need connect outer dropping resistance.</p>
LED Color	<div><div>R</div><div>G</div><div>Y</div><div>O</div><div>B</div><div>W</div></div>				
Life	40000 hours(Reference)				
Rated Voltage	AC/DC6V	AC/DC12V	AC/DC110V		
	AC/DC24V	AC/DC36V	AC/DC220V		
Rated Current	About 15mA		About 3mA		
Dropping Way	Inner resistance		Outer resistance when using 6V lamp		

Note: DC LED and other voltage can be made to order.

Switching Operation >>

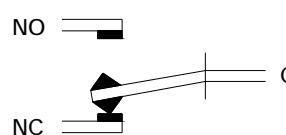
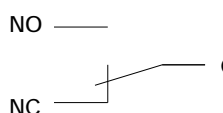
TYPE	C
Diagram	
Sign	
Explanation	Using three terminals, single-break and fast-motion changeover contact.

Terminal Description >>

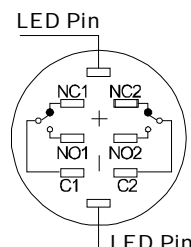
 <p>Can use two sets at most . C1,NO1,NC1 and C2,NO2,NC2 are one set respectively. C is common used, NO is normal opened, NC is normal closed; +、- are lamp terminals, the standard LED have no difference of anode and cathode; The lamp and switch are relatively independent and can use switch or peripheral circuit to control the lamp state.</p>
--

Installation Effect >>



Metal push button



- ⊙ Φ 16mm Diameter
- ⊙ Switch Rating: 3A/250VAC
- ⊙ Contact Configuration: 1NO1NC/2NO2NC
- ⊙ Operation Type: Momentary/Latching
- ⊙ The Front Shape: Flat Round
- ⊙ The Crust Material: Stainless Steel/ Nickel Plated Brass
- ⊙ IP Degree: IP40/IP67, IK09

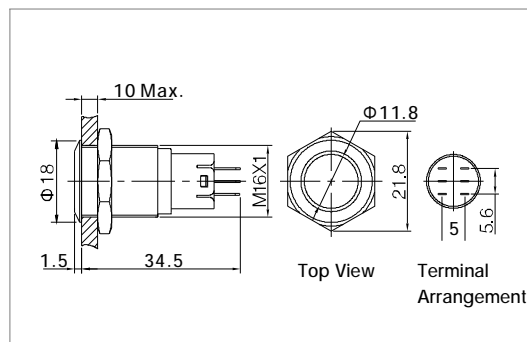

Metal dot illuminated push button



- ⊙ Φ 16mm Diameter
- ⊙ Switch Rating: 3A/250VAC
- ⊙ Contact Configuration: 1NO1NC/2NO2NC
- ⊙ Operation Type: Momentary/Latching
- ⊙ The Front Shape: Flat Round
- ⊙ The Crust Material: Stainless Steel/ Nickel Plated Brass
- ⊙ Dot Illuminated
- ⊙ IP Degree: IP40/IP67, IK09

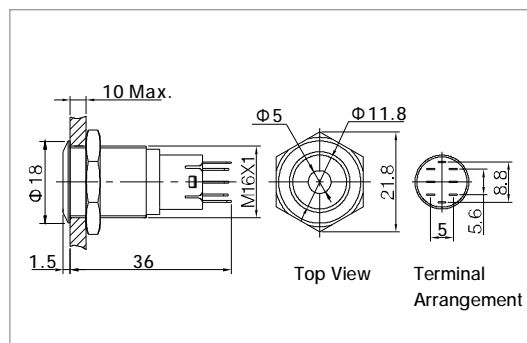

Metal ring illuminated push button



- ⊙ Φ 16mm Diameter
- ⊙ Switch Rating: 3A/250VAC
- ⊙ Contact Configuration: 1NO1NC/2NO2NC
- ⊙ Operation Type: Momentary/Latching
- ⊙ The Front Shape: Flat Round
- ⊙ The Crust Material: Stainless Steel/ Nickel Plated Brass
- ⊙ Ring Illuminated
- ⊙ IP Degree: IP40/IP67, IK09

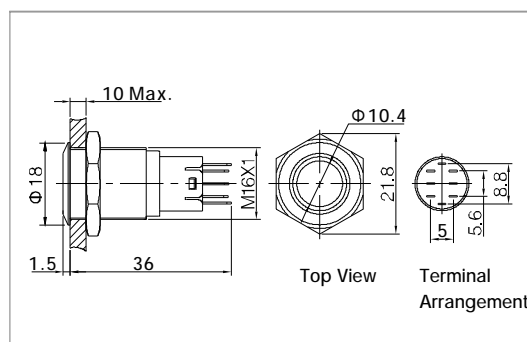

Metal push button



- ⊙ Φ 16mm Diameter
- ⊙ Switch Rating: 3A/250VAC
- ⊙ Contact Configuration: 1NO1NC/2NO2NC
- ⊙ Operation Type: Momentary/Latching
- ⊙ The Front Shape: High Round
- ⊙ The Crust Material: Stainless Steel/ Nickel Plated Brass
- ⊙ IP Degree: IP40/IP67, IK09

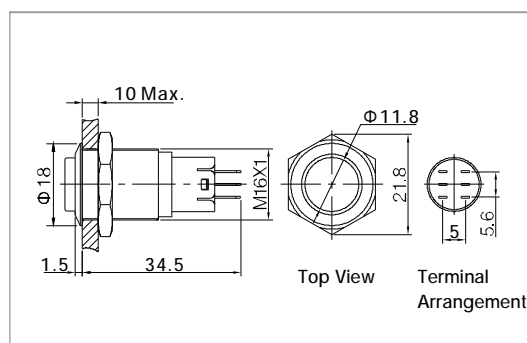

Metal dot illuminated push button



- ⊙ Φ 16mm Diameter
- ⊙ Switch Rating: 3A/250VAC
- ⊙ Contact Configuration: 1NO1NC/2NO2NC
- ⊙ Operation Type: Momentary/Latching
- ⊙ The Front Shape: High Round
- ⊙ The Crust Material: Stainless Steel/ Nickel Plated Brass
- ⊙ Dot Illuminated
- ⊙ IP Degree: IP40/IP67, IK09

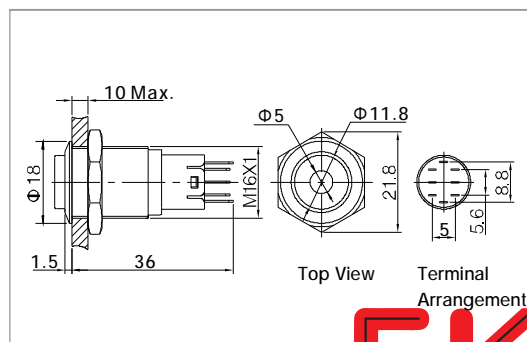

Metal ring illuminated push button



- ◎ $\Phi 16$ mm Diameter
- ◎ Switch Rating: 3A/250VAC
- ◎ Contact Configuration: 1NO1NC/2NO2NC
- ◎ Operation Type: Momentary/Latching
- ◎ The Front Shape: High Round
- ◎ The Crust Material: Stainless Steel/Nickel Plated Brass
- ◎ Ring Illuminated
- ◎ IP Degree: IP40/IP67, IK09

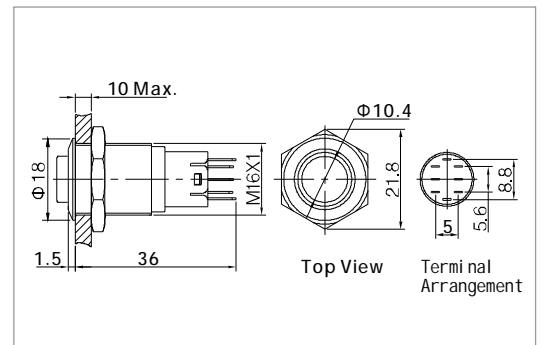

Specification		LAS2GQF-□■/◎/☆ LAS2GQH-□■/◎/☆	LAS2GQF-□■D/△/▲/◎/☆ LAS2GQH-□■D/△/▲/◎/☆	LAS2GQF-□■E/△/▲/◎/☆ LAS2GQH-□■E/△/▲/◎/☆
The Front Shape		Flat Round High Round	Flat Round High Round	Flat Round High Round
Terminal Type		Pin Terminal(1.8×0.4mm)	Pin Terminal(1.8×0.4mm)	Pin Terminal(1.8×0.4mm)
Switching		C(single-break fast-motion changeover contact)	C(single-break fast-motion changeover contact)	C(single-break fast-motion changeover contact)
Max. Switch Rating		Ith:3A Ui:250VAC	Ith:3A Ui:250VAC	Ith:3A Ui:250VAC
Contact Resistance		≤50mΩ	≤50mΩ	≤50mΩ
Insulation Resistance		≥1000MΩ	≥1000MΩ	≥1000MΩ
Dielectric Intensity		2000VAC	2000VAC	2000VAC
Operating Temp		-20℃ ~ +55℃	-20℃ ~ +55℃	-20℃ ~ +55℃
Mechanical Life		200,000 cycles	200,000 cycles	200,000 cycles
Electrical Life		50,000 cycles	50,000 cycles	50,000 cycles
Panel Thickness		1 ~ 10mm	1 ~ 10mm	1 ~ 10mm
Torque		5 ~ 14Nm	5 ~ 14Nm	5 ~ 14Nm
Operation Pressure		2.5 ~ 4N	2.5 ~ 4N	2.5 ~ 4N
Operation Travel		About 2.8mm	About 2.8mm	About 2.8mm
IP Degree		IP40/IP67, IK09	IP40/IP67, IK09	IP40/IP67, IK09
Material	Contact	Silver Alloy	Silver Alloy	Silver Alloy
	Button	Stainless Steel/Nickel Plated Brass	Stainless Steel/Nickel Plated Brass	Stainless Steel/Nickel Plated Brass
	Body	Stainless Steel/Nickel Plated Brass	Stainless Steel/Nickel Plated Brass	Stainless Steel/Nickel Plated Brass
	Base	PBT	PBT	PBT
LED Spec.	RoHS	Made to order	Made to order	Made to order
	Type	Without Lamp	Dot Illuminated(LED)	Ring Illuminated(LED)
	Rated Voltage	—	6V / 12V / 24V / 110V / 220V	6V / 12V / 24V / 110V / 220V
	Color	—	R G Y O B W	R G Y O B W
Life		—	40000 hours	40000 hours

Made in China