

Manual Taped Axial Lead Forming Machine



Features:

- Manual taped lead forming machine is used to lead-cutting and forming of tapes resistors, diodes, and other axial components.
- It finishes lead-cutting and forming at the same time, suitable for high volume production.
- The forming span and length are adjustable.
- Made of steel materials cutter imported from Japan, its cutters are durable.
- It can form U-shaped (horizontal) and F-shaped (vertical) leads.
- The U-shape has a special spec US-shape, which points at components of small forming span.

Specifications:

Name	Manual tapes resistance forming machine U/F
Efficiency	2500~5000 pcs/h
Dimensions (LxWxH)	200x180x200(MM)
Application	Resistances/diodes
Weight	15Kg

Packing List:

No.	Item name	Unit /pc
1	Components holder	1
2	Support holder	1
3	Handle	1
4	Components box	1
5	Six angle wrench	1
6	User manual	1
7	Machine body	1

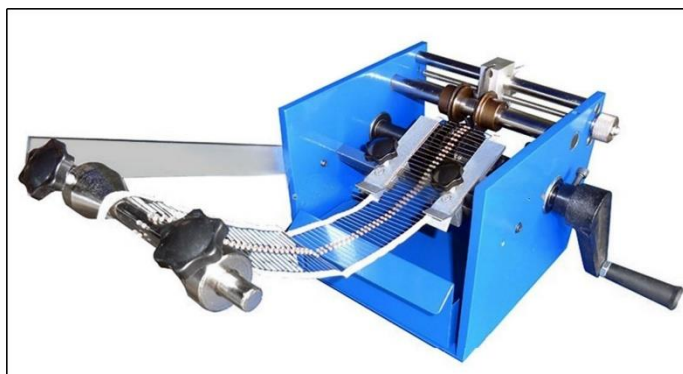

Manual Resistance taped forming and cutting machine (F Type):

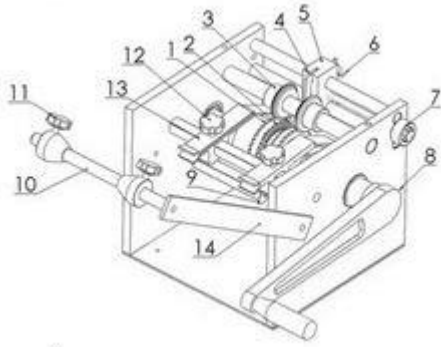

No.	Items	No.	Items
1	Cutting gear	9	Components
2	Forming gear	10	Component
3	Round cutter	11	Plum button
4	Forming blade	12	Plum button
5	Forming blade	13	Components
6	Screw	14	Support
7	Adjust pole	15	
8	Handle	16	

Manual Resistance taped forming and cutting machine (U Type):

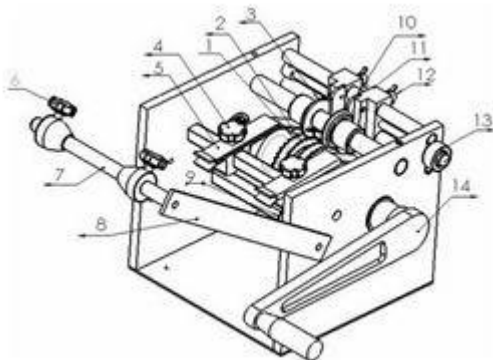

No.	Items	No.	Items
1	Cutting gear	9	Components out
2	Forming gear	10	Forming blade
3	Round cutter	11	Forming blade A1
4	Plum button	12	Screw
5	Components in	13	Adjust pole
6	Plum button	14	Handle
7	Components holder	15	
8	Support holder	16	

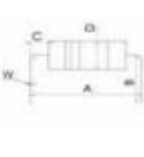
F type	U type
	
A 4—15mm	6—40mm
B 2—15mm	3.5—15mm
C 3mm	1.3—12mm
D 1.5—6mm	1.5—6mm
W 0.35—1mm	0.35—1mm
H 25mm	
P 4—13.5mm	

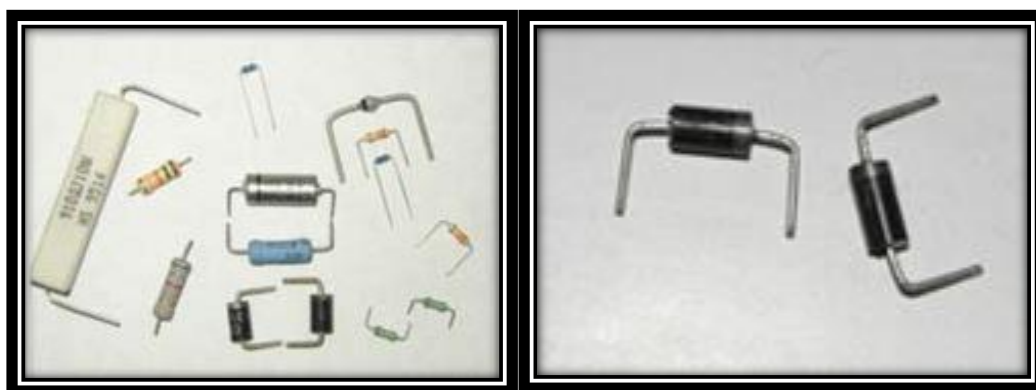

Note:

Please check and ensure all screws are fastening before using manual forming machine; operators should avoid to spares crash like cutting teeth, forming teeth, round cutter and forming blade because they are heat treatment parts; it is forbidden that components are into gear that gears will crack; Bending space can be adjustable according to components lead size.

Install Guide:

- Firstly, please check packing list and read user manual carefully.
- Secondly, take the resistance forming machine, put on level working station and fix it well.
- The third install the handle with wrench; rotate the handle and ensure all parts and gears are working well.
- Install support pole and components pole (see the structure)

Maintenance:

- Please clean waste after finishing forming and cutting.
- Keep forming gear and cutter gear lubricate; operators can add small amount oil every 3-5 days.
- Wipe little oil on parts to protect them if the forming and cutting machine does not work for long time.

Item Photos:



Made in China