

# SONOFF

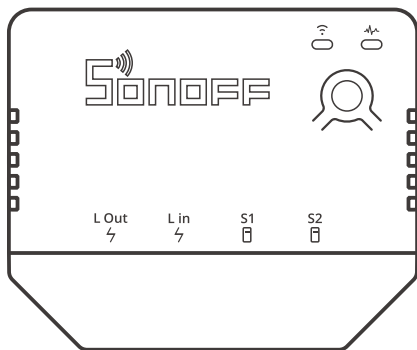

## ZBMINI-L

User manual V1.0



### Smart Switch

(No Neutral Required)

## Product introduction

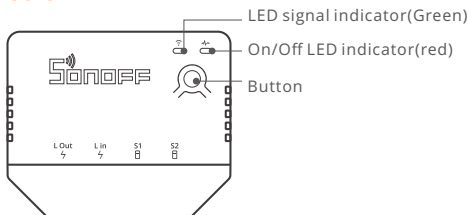

ⓘ The device weight is less than 1 kg. The installation height of less than 2 m is recommended.

## LED indicator status instruction

LED indicator status	Status instruction
Green LED indicator slow flashes	Pairing mode
Green LED indicator keeps on	Device is on line
Green LED indicator quick flashes	Abnormal network connection ZBMINI-L and router connect normally, but router and the hub are disconnected
Green LED indicator slow flashes	Abnormal network connection Slow flashing under non-pairing state: ZBMINI-L and the parent device are disconnected
Red LED indicator on/off	Device on/off

## Features

SONOFF Zigbee 3.0 Smart Switch (No Neutral Required) allows you to remote control, schedule on/off and set smart scenes to trigger other devices, etc. by connecting Zigbee hub.



Remote Control



Single/Countdown  
Timing



Voice Control



Share Control



Smart Scene



External Switch



Power on State



Camera Linking

ⓘ Above functions are determined by the connected ZigBee Hub.

## Power off

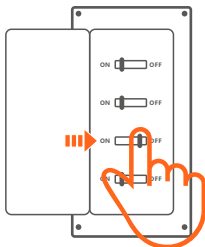

⚠ Please install and maintain the device by a professional electrician. To avoid electric shock hazard, do not operate any connection or contact the terminal connector while the device is powered on!

## Wiring instruction

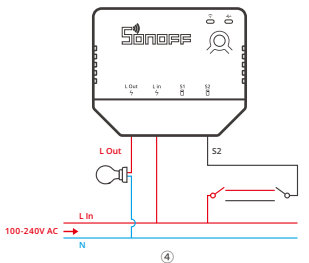
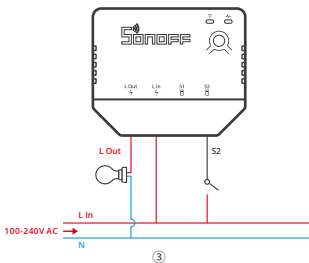
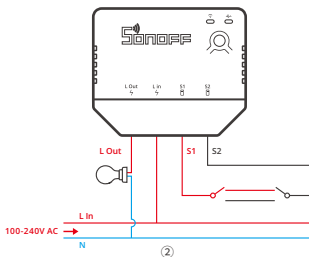
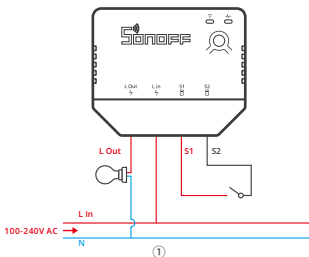

⚠ For the above ③④ wiring methods, please ensure the proper wiring and powering of the L in terminal, otherwise it will cause the device to work abnormally.

- ⚠ Supported switches are rocker switch and push button and factory default by supporting rocker switch.

**Method of change the switch type:** Short-press the button 3 times, then the red LED indicator will quick flash 3 times to indicate that the switch mode is changed successfully.

- ⚠ Make sure all wires are connected correctly.

## Operating instruction

### Pair with eWeLink App

#### 1. Download the eWeLink App



Android™ & iOS

#### 2. Pair SONOFF ZB Bridge to your eWeLink account

#### 3. Power on

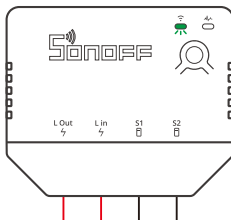

After powering on, the device will enter the pairing mode defaulted during the first use and the Zigbee LED signal indicator will “flash slowly”.

- ⚠ The device will exit the pairing mode if it doesn't be paired within 3mins. If you want to enter again, long-press the button of the device for 5s until the Zigbee signal indicator “slow flashes” then release.

#### 4. Add ZBMINI-L to the ZB Bridge

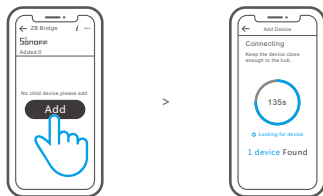

Open eWeLink App, tap "Add" icon on the ZB Bridge interface, then wait to looking for and add the sub-devices.

⚠ If the addition failed, move the sub-device closer to the Bridge and try again.

### Pair with Amazon Echo

1. Download the latest Amazon Alexa App and pair it with Amazon Echo with built-in Zigbee hub.
2. Power on ZBMINI-L, then it defaulted to enter the pairing mode and the Zigbee LED signal indicator "flashes slowly".

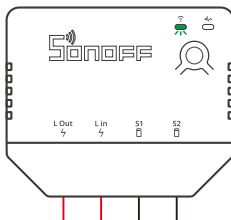

3. Ask the Alexa Echo to discover the devices automatically by saying "Alexa, discover my devices".

⚠ The device will exit the pairing mode if it doesn't be paired within 3mins. If you want to enter again, long-press the button of the device for 5s until the Zigbee signal indicator "slow flashes" then release.

⚠ If the addition failed, move the sub-device closer to the Bridge and try again.

## More recommended App and Hub



SmartThings

In addition to SONOFF ZB Bridge, this device is also supported:  
Samsung SmartThings hub.

### Gateway adding instruction:

1. Refer to the gateway user manual to download the matched APP and get it paired.
2. Set the ZBMINI-L to the pairing mode
3. Add ZBMINI-L according to the prompt of APP. Please select eWeLink or SONOFF when adding.

⚠ If the addition failed, move the sub-device closer to the Bridge and try again.

## Specifications

Model	ZBMINI-L
Input	100-240V AC 50/60Hz 6A Max
Output	100-240V AC 50/60Hz 6A Max
Max. load	Resistive load: 1380W Max @230V, 720W Max @120V LED: 300W Max @230V, 150W Max @120V
Communication distance	Up to 50m (Empty environment)
Wireless connection	Zigbee 3.0
Working temperature	-10~40°C
Casing material	PC V0
Product Size	54x45x24mm
Certification	TUV/CE/FCC/UKCA/RoHS

⚠ Unsupported to use with other Inductive loads such as fan.

## Factory reset

Return the device to its factory settings in any following ways (Device will enter the pairing mode automatically after resetting)

1. Press 10 consecutive times the connected external switch, then the device will turn on and off 3 times automatically to indicate that setting successfully.
2. Long-press the device for 5s.
3. Delete the sub-device on eWeLink App

## Supported voice assistant



## FCC Warning

Changes or modifications not expressly approved by the party responsible for compliance could avoid the user's authority to operate the equipment.

This device complies with part 15 of the FCC Rules. Operation is subject to the following two conditions: (1) This device may not cause harmful interference, and (2) this device must accept any interference received, including interference that may cause undesired operation.

### **FCC Radiation Exposure Statement:**

This equipment complies with FCC radiation exposure limits set forth for an uncontrolled environment. This equipment should be installed and operated with minimum distance 20cm between the radiator & your body. This transmitter must not be co-located or operating in conjunction with any other antenna or transmitter.

### **Note:**

This equipment has been tested and found to comply with the limits for a Class B digital device, pursuant to part 15 of the FCC Rules. These limits are designed to provide reasonable protection against harmful interference in a residential installation. This equipment generates, uses and can radiate radio frequency energy and, if not installed and used in accordance with the instructions, may cause harmful interference to radio communications. However, there is no guarantee that interference will not occur in a particular installation. If this equipment does cause harmful interference to radio or television reception, which can be determined by turning the equipment off and on, the user is encouraged to try to correct the interference by one or more of the following measures:

- Reorient or relocate the receiving antenna.
- Increase the separation between the equipment and receiver.
- Connect the equipment into an outlet on a circuit different from that to which the receiver is connected.
- Consult the dealer or an experienced radio/TV technician for help.