

Mini Smart Home WiFi/IR Universal Remote Controller

Model: RM4C Mini



Features:

- **Voice Control:** Compatible with Alexa and Google Home to control your TV, air conditioner by voice.
- **APP Control:** Control IR devices with IHC **APP** anywhere and anytime (turn off 5Ghz WiFi if there is one. Please use 2.4GHz WiFi). Set up timers to turn devices on / off at a specific time or customize scenes with multiple devices. Turn your basic home devices into smart devices and make life smarter and more convenient.
- **Compatibility:** Large IR database with over 98% IR remote control functions. Support 50,000+ IR (IR only, no RF, compared to RM PRO) controlled devices including your TV, DVD, audio, air conditioner, satellite, PVR and more to program your devices functionality if some cloud data are not available.
- **Scheduled Function:** Activate and schedule daily and customizable features according to your needs.

Specifications:

- Connectivity: Wi-Fi 802.11b / g / n (2.4GHz)
- Compatible OS: iOS 9.0 / Android 4.0 and higher
- Infrared range: $\leq 8\text{m}$ (typical)
- Infrared Frequency: 38kHz
- Working humidity: $\leq 85\%$
- Working temperature: $0-50^{\circ}\text{C}$
- Infrared direction: multi direction infrared
- Voltage: 5V
- Dimensions: $8.5 \times 5 \times 6.5\text{ cm}$
- Weight: 80g

More Product Details:

IR APPLIANCE, FULL INTEGRATION

With RM4C mini, you can control your Home appliances with your mobile phone and support a variety of appliances such as TVs, set-top boxes, and air conditioners



WIFI Intelligent Remote Controller



MULTIPLE SETS OF TIMING CONVENIENT FOR YOUR LIFE

According to your living habits, set time switches for your Home appliances
such as turning on or off the air conditioner at regular intervals



Healthy sleep



Multi group timing



Remote control



Cloud end panel



Intelligent scene



CLOUD IRCODE DATABASE

The cloud red code database covers a large number of Home appliance brands the database is constantly updated and rich, and supports user-defined learning



cloud IR code update



one-button match



WORKS WITH
alexa

works with the
Google Assistant

REMOTE CONTROL

If you are not at Home, you can also turn on/off the Home appliance through your mobile phone or check the status of the electrical switch in real time

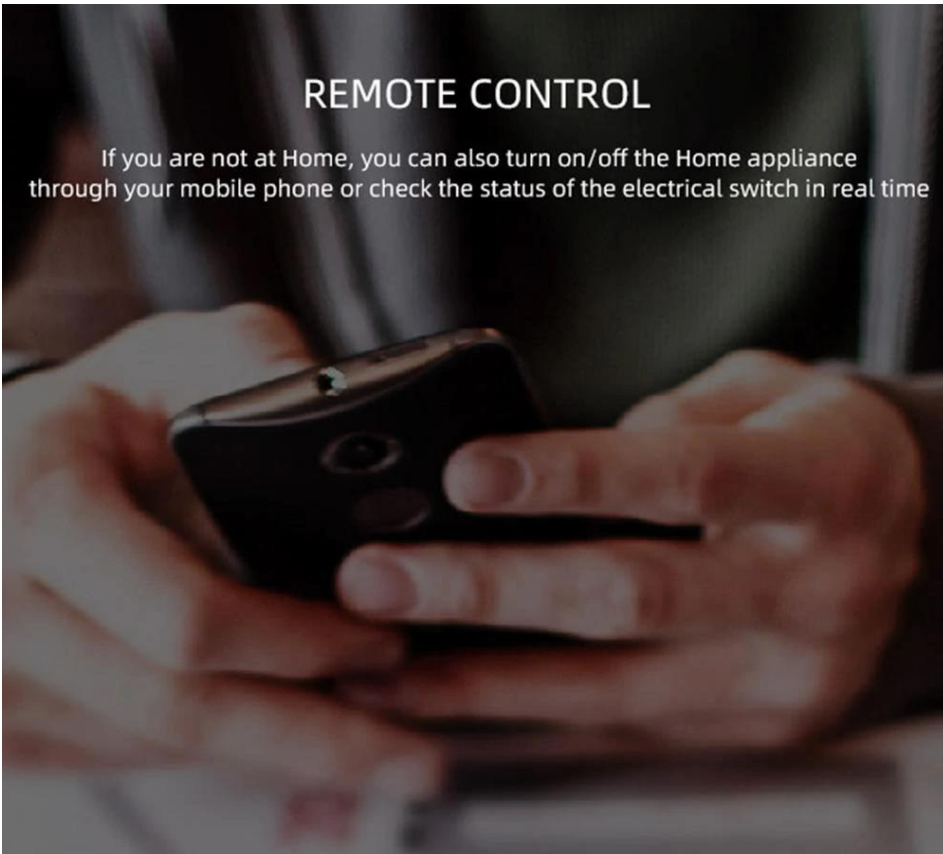

Made in China