

Closed Loop Stepper Motor & Driver Kit

Model: LCDA86H + LC86H2158 Nema34



LCDA86H 2 Phase Closed Loop Driver

Description:

LCDA86H using the latest dedicated motor control DSP chip and vector closed-loop control technology, completely overcome the open-loop stepper motor problem, while significantly enhance the motor high-speed performance, reduce motor heating and reduce motor vibration, improve machine processing speed and accuracy of the machine energy consumption.

Technical Parameters:

1. Voltage input range: VAC: 20~70V Or VDC: 30~100V
2. Maximum peak current: 6A
3. Subdivision range: default 4000/rev, any number of subdivisions can be set through the debug board (200-51200)
4. Pulse limit frequency: 200KHz
5. Signal input: pulse, direction and enable signal
6. Output signal: in-position signal and fault output signal
7. Motor encoder feedback: AB differential input
8. Closed-loop vector control to ensure high-speed and high-torque output of the motor, while ensuring that the motor does not lose step
9. With overvoltage, overcurrent, tracking error and other protection functions

Dimensions Diagram:

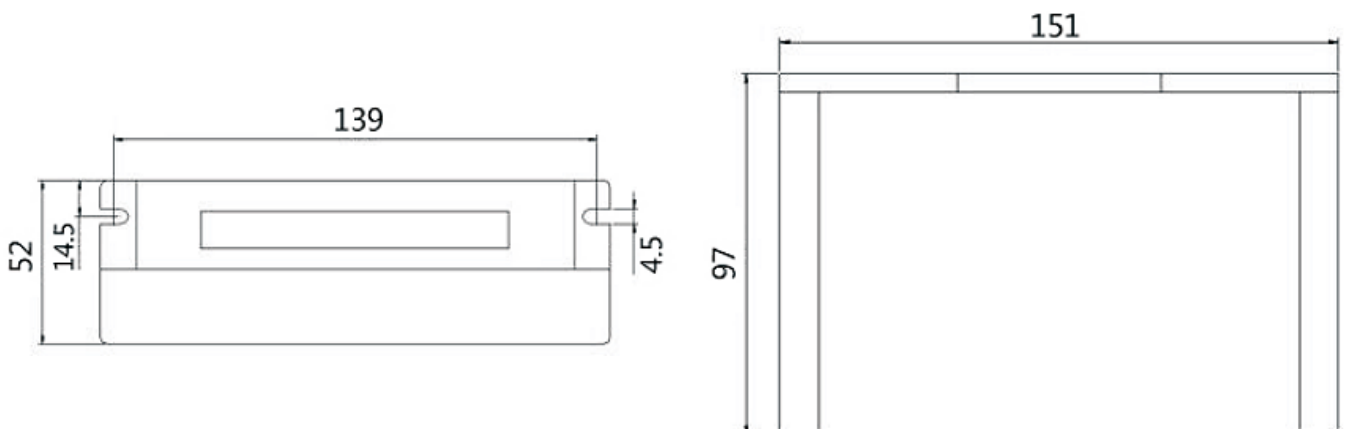

Unit: mm

Wiring:

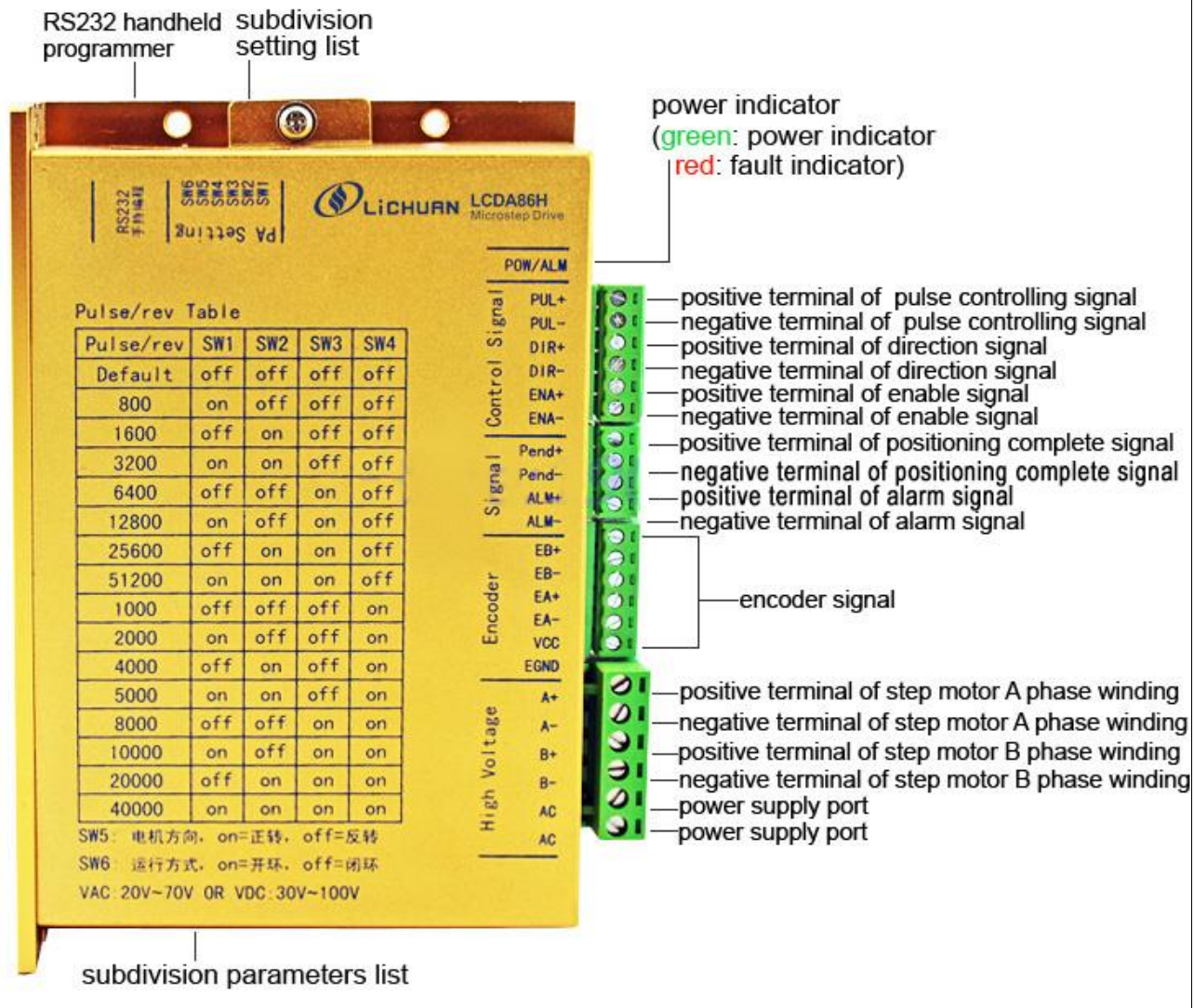

Application Areas:

Suitable for all kinds of small and medium-sized automation equipment, such as: engraving machine, stripping machine, marking machine, cutting machine, laser machine, medical equipment, CNC machine tools, automatic assembly equipment, electronic processing equipment.

LC86H2158 Nema34 2 Phase Closed Loop Stepper Motor

Technical Parameters:

1. Step/angle: 1.8°
2. Length: 156mm
3. Shaft diameter: $\Phi 14\text{mm}$
4. Shaft length: 37mm
5. Shaft extension: Flat key 5x5x25mm
6. Holding torque: 12N.M
7. Current: 7.5A
8. Rotor inertia: 5400g.cm²
9. Encoder line: 1000PPR
10. Lead wire no.: 4
11. Weight: 5.4Kg

Dimensions Diagram:

Outline and mounting dimensions

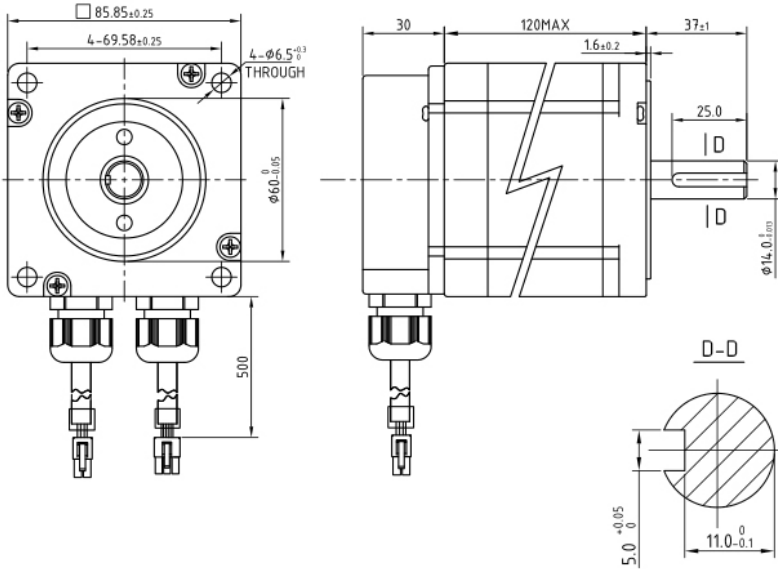

Description of motor output shaft

Model	Shaft Diameter (mm)	Shaft Extension (mm)	Shaft Length (mm)
LC86H260	Φ14	Flat key 5×5×25	37
LC86H268	Φ14	Flat key 5×5×25	37
LC86H280	Φ14	Flat key 5×5×25	37
LC86H298	Φ14	Flat key 5×5×25	37
LC86H2120	Φ14	Flat key 5×5×25	37
LC86H2128	Φ14	Flat key 5×5×25	37
LC86H2160	Φ14	Flat key 5×5×25	37

Wiring:

MOTOR CONNECTIONS

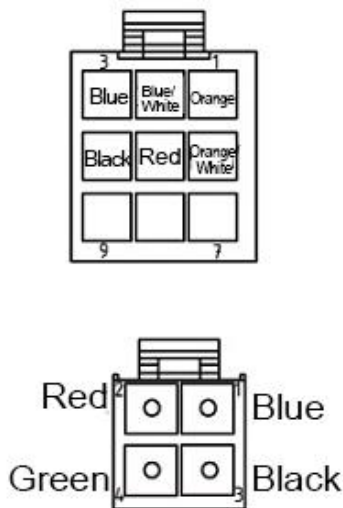
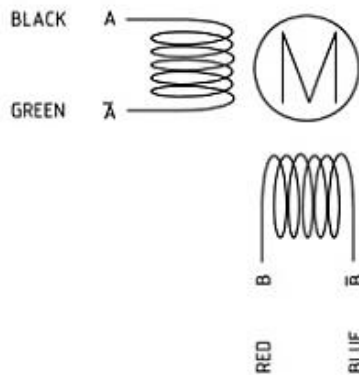

1	Black	EGND
2	Red	+5VCC
3	Blue/ white	EA-
4	Blue	EA+
5	Orange/ White	EB-
6	Orange	EB+

Application Areas:

Suitable for all kinds of motion control automation equipment and instruments, such as: electronic processing and testing, semiconductor packaging, laser cutting and welding, laser phototypesetting, packaging machinery, engraving machine, marking machine, cutting machine, garment plotter, CNC machine tools, automation assembly equipment and so on.

Made in China