

Motor Toy N20



Specifications:

- ✓ Voltage: DC 1.5V
- ✓ Speed: 18000rpm
- ✓ Current: 0.58A
- ✓ Motor Size: 15.3x12x10mm
- ✓ Axis Length: 4mm
- ✓ Shaft Diameter: 1mm
- ✓ Weight: 5.6g

More Detailed Photo:

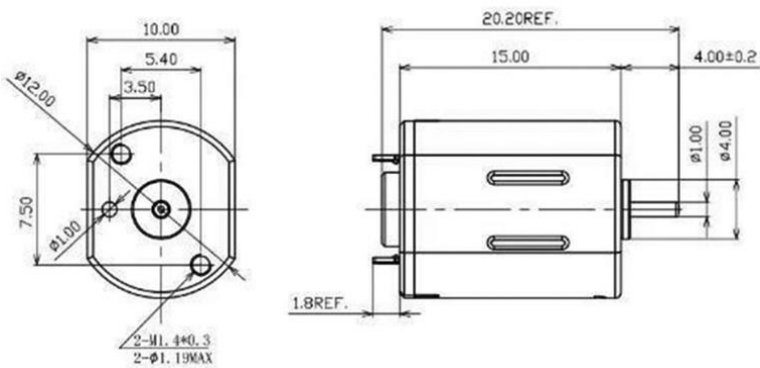

Made in China