

Memory Module Specifications

KVR667D2N5/1G

1GB 128M x 64-Bit DDR2-667
CL5 240-Pin DIMM

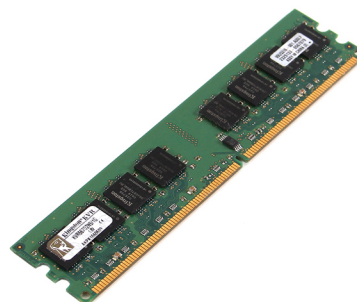

DESCRIPTION

This document describes ValueRAM's 128M x 64-bit 1GB (1024MB) DDR2-667 CL5 SDRAM (Synchronous DRAM) memory module. The components on this module include eight 128M x 8-bit DDR2-667 SDRAM in FBGA packages. This 240-pin DIMM uses gold contact fingers and requires +1.8V. The electrical and mechanical specifications are as follows:

SPECIFICATIONS

Clock Cycle Time (tCK) CL=5	3ns (min.) / 8ns (max.)
Row Cycle Time (tRC)	60ns (min.)
Refresh to Active/Refresh Command Time (tRFC)	127.5ns
Row Active Time (tRAS)	45ns (min.) / 70,000ns (max.)
Single Power Supply of	+1.8V (+/- .1V)
Power	1.225 W (operating)
UL Rating	94 V - 0

Note: The module defined in this data sheet is one of several configurations available under this part number. While all configurations are compatible, the DRAM combination and/or the module height may vary from what is described here.

Figure 1: KVR667D2N5/1G 240-Pin DIMM

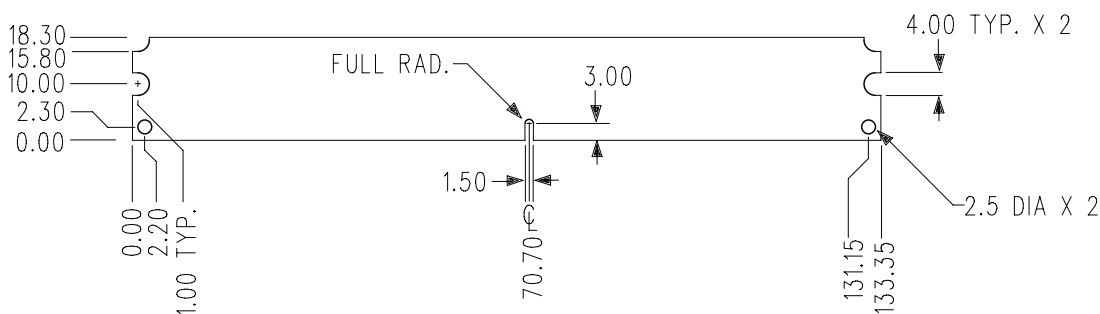
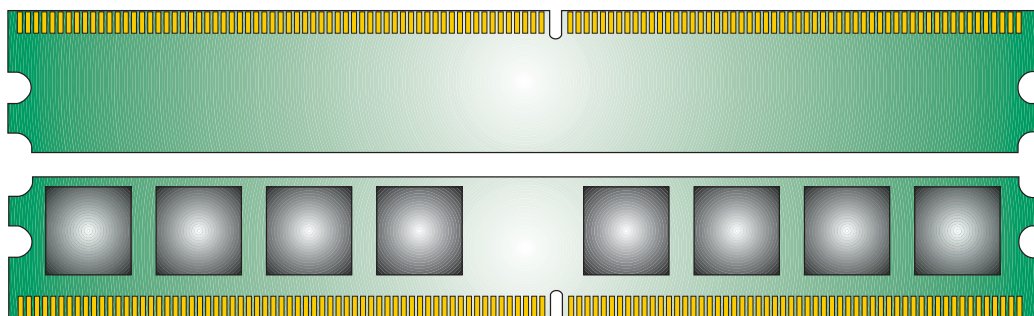

Units : Millimeters

Made in China