

4 USB Port Printer Server

Model: MK-WPS402



Description:

This is a 4 USB port print server that supports a USB printer to print more than one computer to share, does not support multiple printers or other interface printer sharing and does not support the sharing of scanning. Most of the USB port printers are supported, but not all.

The print server uses an IP port to work, so support TCP / IP protocol system can be. The printer driver is installed in your system, the server just needs to transfer port only. So make sure your printer has a corresponding driver available for your system. (Does not support tablet, smart phone).

Features:

- No software, multi-network sharing at the same time.
- Dual LAN port, support VLAN, multi-segment network segment printing
- The device is fully compatible with special models such as the HP 1020, HP P1007, P1008, P1505. It is easy to install and supports IP addresses of four network segments to share printers in different IP segments.
- Equipment installation only needs to add the TCP/IP port, uses the standard RAW agreement.
- Newly developed firmware, more convenient for your office use.

Specifications:

Brand	WISIYILINK	CPU	400MHz
Model	MK-WPS402	Flash Memory	8MB
Number of Printers	4	RAM	32MB
Connection	Wired	Dimensions	11.2x7.6x3cm
Network Access	10/100 Mbps adaptive RJ45 Interface x2	Material	Iron shell
Network Protocol	IEEE 802.3; RAW	Operating System	XP/Vista/Win7/Win8/Win10 (32/64Bit)
Number of Users	2	Applicable to	Canon, HP, Epson, Brother, Lenovo...

Connection Diagram:

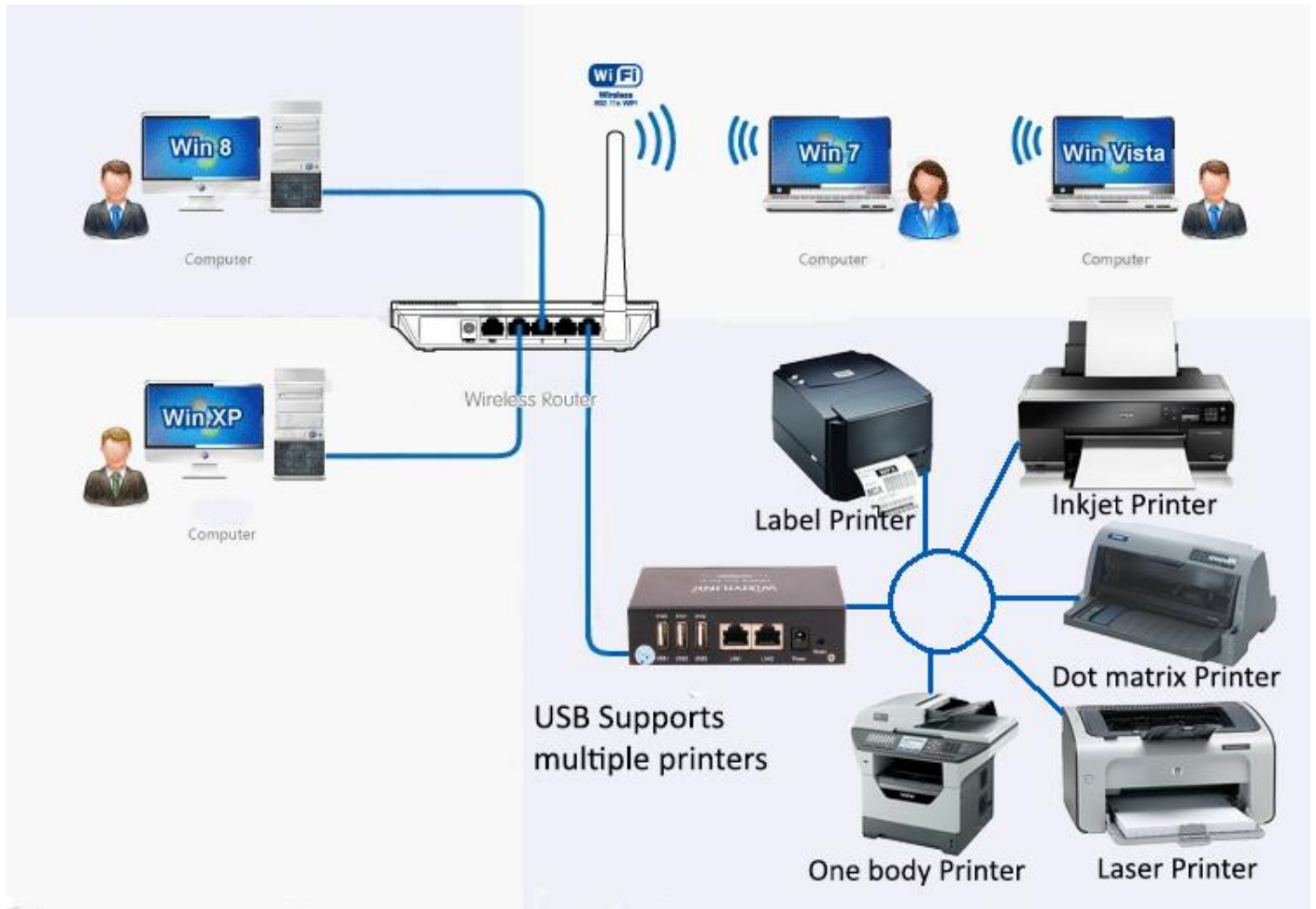

Made in China